

Star Knobs

Aluminum / Stainless Steel

SPECIFICATION

Types

- Type **AM**: Star knobs Aluminum, matte finish (tumbled), threaded stud stainless steel
- Type **AP**: Star knobs Aluminum, polished, threaded stud stainless steel
- Type **ES**: Star knobs Stainless Steel, AISI 303
- Type **A4P**: Star knobs Stainless Steel, AISI 316

Knob

Aluminum

Forged

Matte finish (tumbled) **AM**

Polished **AP**

Stainless steel precision casting AISI CF-8 **ES**

Matte shot-blasted

Stainless steel precision casting AISI 316 **A4P**

Polished

Threaded stud

Stainless steel AISI 303

The threaded stud is screwed in and secured by a cross-dowel.



INFORMATION

Star knobs GN 6336.5 satisfy the dimensions of the DIN 6336 (see page 238) Type L but differ in terms of their non-scooping geometry, which makes cleaning easier and helps prevent possible build-up of dirt.

They are suitable for areas with special hygiene requirements and, thanks to the material used, for applications in highly corrosive environments.

TECHNICAL INFORMATION

- Stainless Steel Characteristics (see page A26)

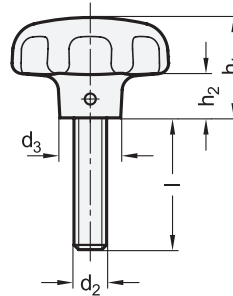
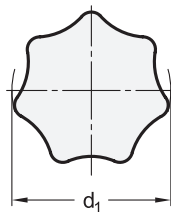

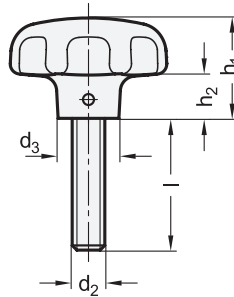
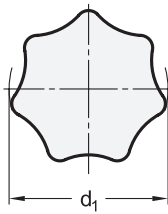

GN 6336.5-AM

Description	d1	d2	l ≈	d3	h1	h2	△
GN 6336.5-AM-40-M8-20	40	M 8	20	14	25	12	44
GN 6336.5-AM-40-M8-25	40	M 8	25	14	25	12	45
GN 6336.5-AM-40-M8-30	40	M 8	30	14	25	12	47
GN 6336.5-AM-40-M8-40	40	M 8	40	14	25	12	50
GN 6336.5-AM-50-M10-20	50	M 10	20	18	32	15	80
GN 6336.5-AM-50-M10-25	50	M 10	25	18	32	15	82
GN 6336.5-AM-50-M10-30	50	M 10	30	18	32	15	92
GN 6336.5-AM-50-M10-45	50	M 10	45	18	32	15	97
GN 6336.5-AM-50-M10-55	50	M 10	55	18	32	15	100
GN 6336.5-AM-63-M12-30	63	M 12	30	20	40	19	150
GN 6336.5-AM-63-M12-40	63	M 12	40	20	40	19	157
GN 6336.5-AM-63-M12-50	63	M 12	50	20	40	19	164

GN 6336.5-A4P

STAINLESS STEEL

Description	d1	d2	l	d3	h1	h2	△
GN 6336.5-A4P-40-M8-20	40	M 8	20	14	25	12	117
GN 6336.5-A4P-40-M8-25	40	M 8	25	14	25	12	119
GN 6336.5-A4P-40-M8-30	40	M 8	30	14	25	12	121
GN 6336.5-A4P-40-M8-40	40	M 8	40	14	25	12	125
GN 6336.5-A4P-50-M10-20	50	M 10	20	18	32	15	229
GN 6336.5-A4P-50-M10-25	50	M 10	25	18	32	15	233
GN 6336.5-A4P-50-M10-30	50	M 10	30	18	32	15	239
GN 6336.5-A4P-50-M10-45	50	M 10	45	18	32	15	240
GN 6336.5-A4P-50-M10-55	50	M 10	55	18	32	15	254
GN 6336.5-A4P-63-M12-30	63	M 12	30	20	40	19	437
GN 6336.5-A4P-63-M12-40	63	M 12	40	20	40	19	446
GN 6336.5-A4P-63-M12-50	63	M 12	50	20	40	19	454

GN 6336.5-AP

Description	d1	d2	l	d3	h1	h2	△
GN 6336.5-AP-40-M8-20	40	M 8	20	14	25	12	43
GN 6336.5-AP-40-M8-25	40	M 8	25	14	25	12	45
GN 6336.5-AP-40-M8-30	40	M 8	30	14	25	12	46
GN 6336.5-AP-40-M8-40	40	M 8	40	14	25	12	50
GN 6336.5-AP-50-M10-20	50	M 10	20	18	32	15	79
GN 6336.5-AP-50-M10-25	50	M 10	25	18	32	15	81
GN 6336.5-AP-50-M10-30	50	M 10	30	18	32	15	91
GN 6336.5-AP-50-M10-45	50	M 10	45	18	32	15	95
GN 6336.5-AP-50-M10-55	50	M 10	55	18	32	15	96
GN 6336.5-AP-63-M12-30	63	M 12	30	20	40	19	150
GN 6336.5-AP-63-M12-40	63	M 12	40	20	40	19	155
GN 6336.5-AP-63-M12-50	63	M 12	50	20	40	19	164

GN 6336.5-ES

STAINLESS STEEL

Description	d1	d2	l	d3	h1	h2	△
GN 6336.5-ES-40-M8-20	40	M 8	20	14	25	12	80
GN 6336.5-ES-40-M8-25	40	M 8	25	14	25	12	88
GN 6336.5-ES-40-M8-30	40	M 8	30	14	25	12	90
GN 6336.5-ES-40-M8-40	40	M 8	40	14	25	12	91
GN 6336.5-ES-50-M10-20	50	M 10	20	18	32	15	180
GN 6336.5-ES-50-M10-25	50	M 10	25	18	32	15	184
GN 6336.5-ES-50-M10-30	50	M 10	30	18	32	15	186
GN 6336.5-ES-50-M10-45	50	M 10	45	18	32	15	193
GN 6336.5-ES-50-M10-55	50	M 10	55	18	32	15	197
GN 6336.5-ES-63-M12-30	63	M 12	30	20	40	19	321
GN 6336.5-ES-63-M12-40	63	M 12	40	20	40	19	334
GN 6336.5-ES-63-M12-50	63	M 12	50	20	40	19	340

